

IEL.N SOFT

Two-volume handles



ELESA Original design



SOFT

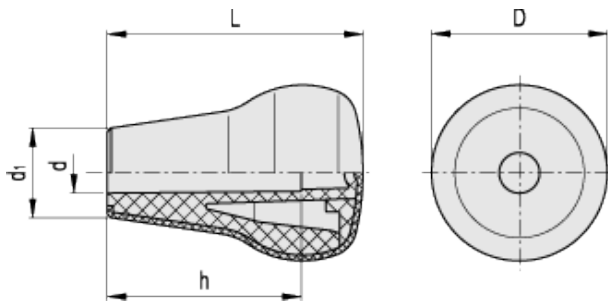

technical informations

Material

High-resilience polypropylene based (PP) technopolymer coated with "soft-touch" thermoplastic elastomer (TPE) chemically bonded, hardness 70 Shore A.

The coating material is certified in compliance with FDA (U.S. Food and Drug Administration).

Resistant to solvents, oils, greases and other chemical agents.

Colour

Black, matte finish.

Standard execution

Plain blind hole.

The elastic coupling by press-fit assembly on h9 tolerance drawn stock bars, is not affected by vibrations and prevents the handle from slipping off (see [Technical Data](#)).

Features and applications

Handles coated with "soft-touch" elastomer: it improves the grip even in the presence of oils, greases and sweat from the hand. Particularly suitable for applications on fitness machines, tools and machines for gardening and goods transport, high-precision instruments and disability aids.

Assembly instructions

Fit the handle onto slight chamfered shaft end and push as far as possible by hand or by means of a small press. Alternatively it is possible to tap the handle with a plastic or wooden mallet until firmly in place. In this case we strongly recommend to use a cloth or other suitable soft material over the product to avoid any surface damage.

Standard Elements		Main dimensions			Mounting hole		Weight
Code	Description	L	D	d ₁	d	h	g
26642	IEL.47 N-12 SOFT	47	45	28	12	34	48
26661	IEL.65 N-10 SOFT	65	45	23	10	50	56
26662	IEL.65 N-12 SOFT	65	45	23	12	50	55



ELESA and GANTER models all rights reserved in accordance with the law. Always mention the source when reproducing our drawings.

STANDARD MACHINE ELEMENTS WORLDWIDE